

STORM MEDIUM PLUTO D2W

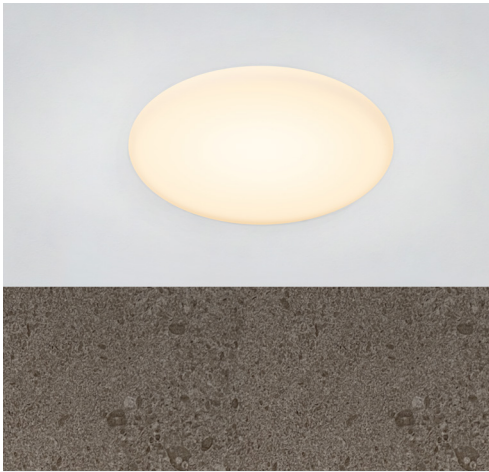

STORM SYSTEM®

The Storm Medium pluto is part of the STORM SYSTEM® MEDIUM collection. A collection that includes a wide range of special designed products. The STORM SYSTEM® collection is carefully designed to flush the surface of any ceiling or wall, and all products will appear with an absolute minimum of tolerance and visibility.

Storm Medium Pluto is designed to flush ceilings or walls. A soft light shines through the glass, and provides a pleasant light. A perfect solution for a night light.

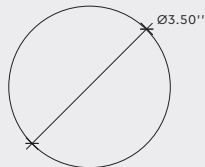
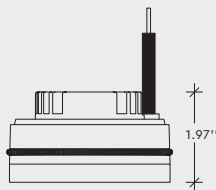

Do not forget the Mudkit or wood kit



The crossed-out wheeled bin symbol indicates that the item should be disposed of separately from household waste. The item should be handed in for recycling in accordance with local environmental regulations for waste disposal

For more information, please contact info@onea.dk

DATA

Collection	STORM SYSTEM®
Product	Storm Medium Pluto- D2W
Article no.	1N01.0130.6266

SPECIFICATIONS

Weight	12 oz
Materials	Aluminium and Glass
IP protection grade	IP65 (heat shrink cable connection is required)
Labelling	



Conforms to ANSI/UL Std. UL 2108.

Cert. to CAN/CSA Std. CSA C22.2#250.13

Intertek
5005519

Fixture finish	Glass
Light Source	LED Constant Current (included) For IES/LDT lux files review STORM SYSTEM® - LUX FILES >
Supply	8W 35V 210mA
CCT	2700 - 2000K
Insulation class	Class III

ADDITIONAL REQUIREMENTS

Junction kit	review STORM SYSTEM® - CONFIGURATION > This product shall always be powered by SELV LED driver, output voltage of this driver in open circuit must not exceed 60V. Do NOT cover the LED driver or locate LED driver on top of light fixture. For further support contact LITES ON WEST 245 West 29th Street, 6th floor NY, NY 10001 T: 212 775 6363 F: 212 775 0355 E: info@litesonwest.com
--------------	--

NOTE

The light source of this light fixture is not replaceable; when the light source reaches its end of life the whole light fixture must be replaced.

Be cautious while putting on/off the power supply, as excess current, excess voltage or reverse voltage may get injected to the device in some cases.

INSTALLATION DEPTH

For specific light source conditions
- review STORM SYSTEM® - INSTALLATION DEPTH >

IMPORTANT INFORMATION

Installation and mounting must be performed by a certified electrician only, and instructions must be followed.

CLEANING AND MAINTENANCE:

Use a soft moist cloth for cleaning. No further maintenance is required.

WARRANTY:

If the product is defect, please contact your supplier immediately. Please note that warranty will not apply in case of wrongful use or if unskilled personnel attempts to repair.

COMPONENTS

- Storm Medium Pluto
- Suction cup for disassembly

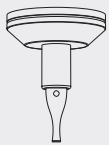
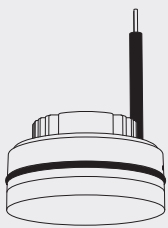

PLEASE NOTE:

If the spring on the fixture is damaged, do not proceed installation – contact your dealer!

STORM MEDIUM PLUTO

ASSEMBLY INSTRUCTION

STEP 1

Make sure main power is off!

Mount the chosen junction kit.

Mount the fixture into the plaster ring/ backmounted ring. Do this by slightly rotating the fixture into the plaster ring/ back-mounted ring.

NOTE: When rotating the fixture choose the direction with the least resistance.

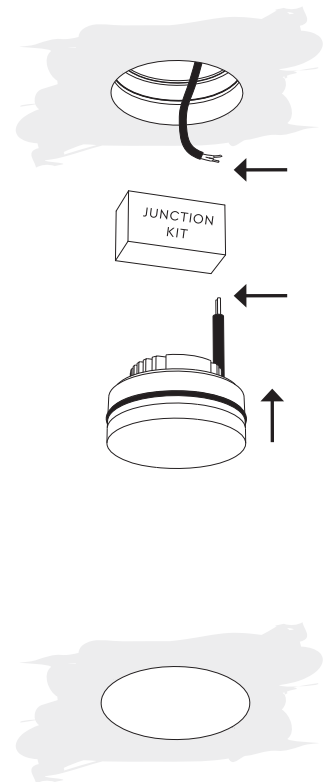

IMPORTANT INFORMATION

Disassembly must be performed by a certified electrician only, and instructions must be followed.

WARRANTY:

If the product is defect, please contact your supplier immediately. Please note that warranty will not apply in case of wrongful use or if unskilled personnel attempts to repair.

STORM MEDIUM PLUTO

DISASSEMBLY INSTRUCTION

STEP 1

Make sure main power is off!
Place the suction cup over the fixture.

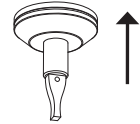
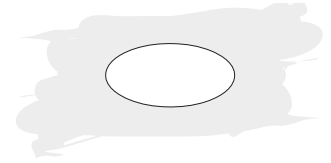

STEP 2

Turn the handle to ensure suction, then pull down gently, whilst slightly rotating.

NOTE: When rotating the fixture choose the direction with the least resistance.

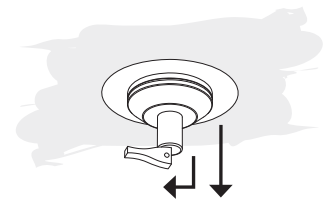

STEP 3

Disconnect the cables

